

Schüco AS PD 75.HI

Aluminium Panorama Design sliding system





The new Schüco AS PD 75.HI Panorama Platform

Since the middle of the 20th century, modern construction has been characterised by a minimalist trend to eliminate redundancy and emphasise quality, while retaining multi-functionality. Schüco has made it its goal to bring all these requirements together, without compromising on design and comfort.

Schüco AS PD 75.HI brings together multi-functionality and style in three product lines, offering the highest technical performance characteristics and expression of design individuality.

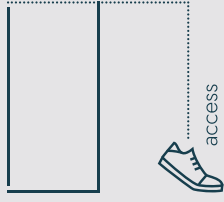

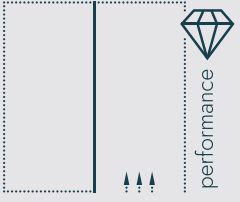
Schüco AS PD 75.HI		
Access Line	Design Line	Performance Line
		
The Access Line focuses on convenience and easy operation	The Design Line fulfils the highest design requirements while ensuring optimum views to the outside	The Performance Line combines the best qualities of all our product lines in one system.

Highlights at a glance

Numerous customisable features, e.g. sun shading and a timber look.



Flush-fitted appearance thanks to the dynamic cover profile and integrated flush pull grip in the outer frame.

The lift-and-slide technology allows for a barrier-free threshold when the sliding door is open and a frameless panorama view when closed.

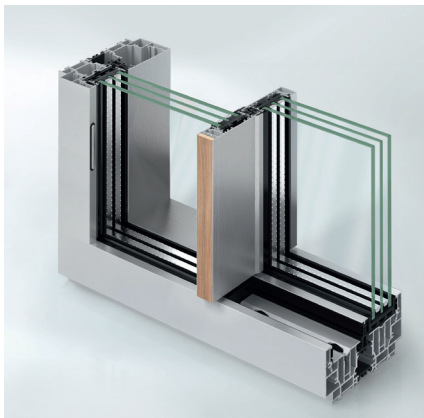

Schüco AS PD 75.HI WoodDesign adds a natural touch to your living spaces



The dynamic cover profile completes the look of the outer frame even when the sliding vents are open. An integrated flush pull grip can also be added to the outer frame of the manual system versions, allowing the pull grip to disappear into the wall when the sliding vent is closed.

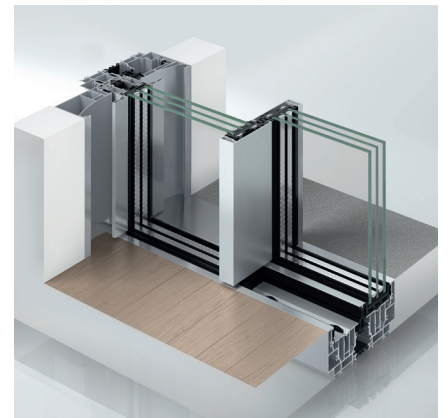

Properties and technical performance values

Properties

- Total basic depth: 218mm
- Vent basic depth: 75mm
- Max. vent width: 3500mm
- Max. vent height: 3500mm
- Max. vent weight: 500kg manual
600kg Performance Line
800kg mechatronic
- Face width of interlock section: 35mm
- Glass thickness: 40-60mm
- Outer frame heights: 65.5mm, 93.5mm, 100mm, 116mm

Tests	Standard	Access Line	Design Line	Performance Line
Wind load resistance	DIN EN 1211:2106-03	Class B4/C2*	Class B4/C2*	Class C2
Air permeability (Class)	DIN EN 1026:2016-3	Class 4*	Class 4	Class 4
Weathertightness (Class)	DIN EN 1027:2016-0	Class 9A*	Class E750	Class E1050
Thermal Insulation up to U_w (W/(m ² K))**	DIN EN 10077-1	1.04 (Glass Ug=0.7 W/(m ² K))	1.02 (Glass Ug=0.7 W/(m ² K))	1.00 (Glass Ug=0.7 W/(m ² K))
		0.86 (Glass Ug=0.5 W/(m ² K))	0.84 (Glass Ug=0.5 W/(m ² K))	0.82 (Glass Ug=0.5 W/(m ² K))
Burglar resistance	DIN V ENV 1627	RC 2	RC 2	RC 3*

*target value

**Dimensioning principles: Type 2A/1, Unit: 4500mm x 3500mm

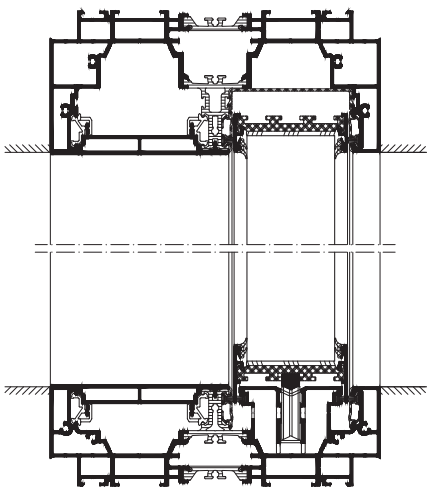

Example: Access Line level threshold

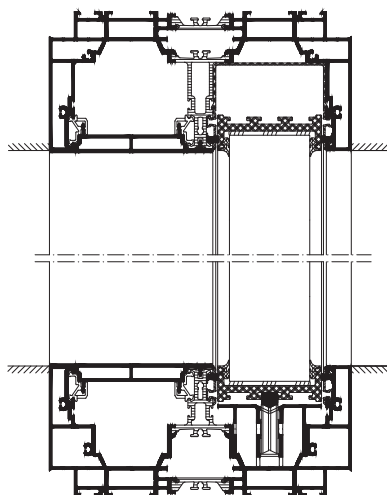

Example: Design Line frameless view

A detailed comparison of the product line

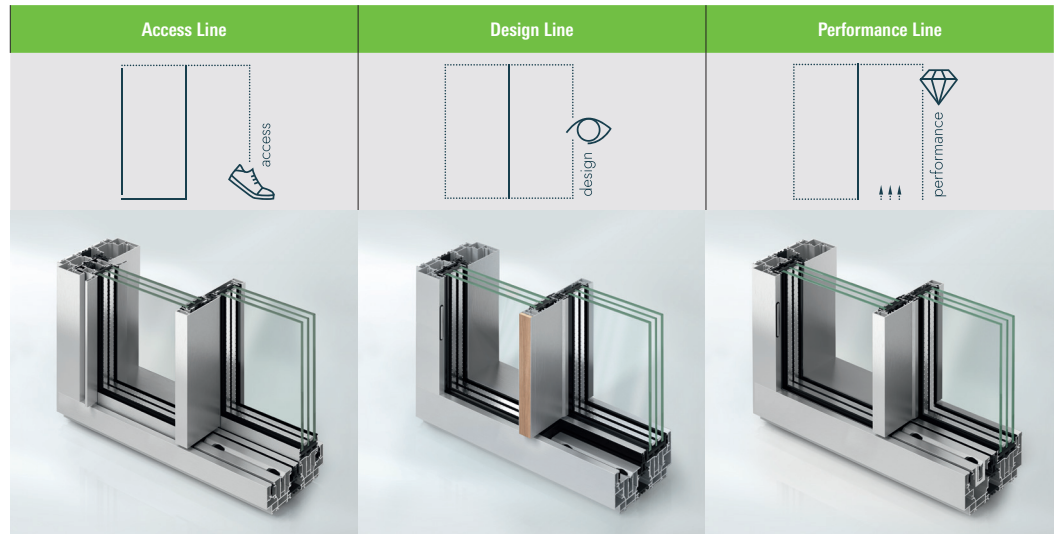

	Access Line	Design Line	Performance Line
Operations			
Manual operation	■	■	
Mechatronic operation	■	■	■
Turn knob	■		
Pull grip	■	■	
Design options			
Frameless appearance		■	■
Barrier-free threshold	■		■
Dynamic cover profile	■	■	■
Integrated flush pull grip		■	
WoodDesign	■	■	■
Features			
Sun shading	■	■	■
Monitoring of closing	■	■	■
Locking in open position	■	■	
Building Skin Control	■	■	■

Opening types

Type 2A

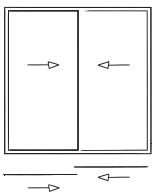

Type 2A/1

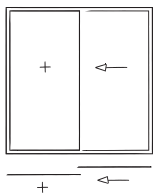

Type 2B

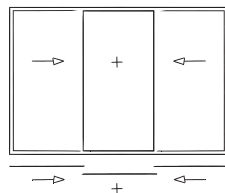

Type 2C

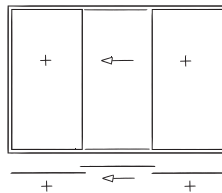

Type 2E

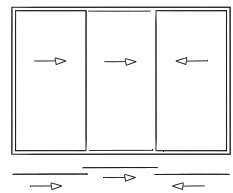

Type 2G

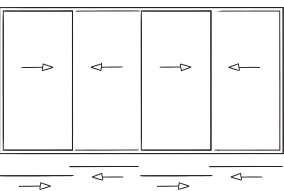

Type 2G/1

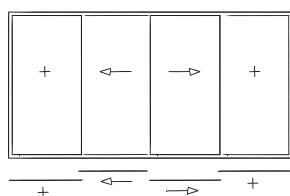

Features in detail



Turn knob

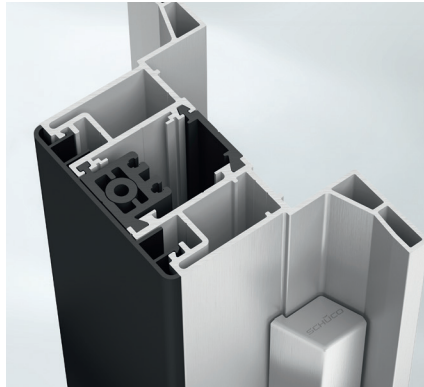

Pull grip

For manual sliding versions, a turn knob in the interlock section or a pull grip can be chosen as operating options. Schüco AS PD 75.HI also offers a combination of these two options for additional security.

Schüco AB ZDS sun shading - minimalistic design with maximum flexibility and resistance.

The external facade-mounted Schüco AB ZDS (Aluminium Blind Zip Design Screen) textile sun shading system is now available for the first time in the Panorama Design segment. The guide tracks and blind box are directly attached to the building structure and do not need to be connected to the sliding system.

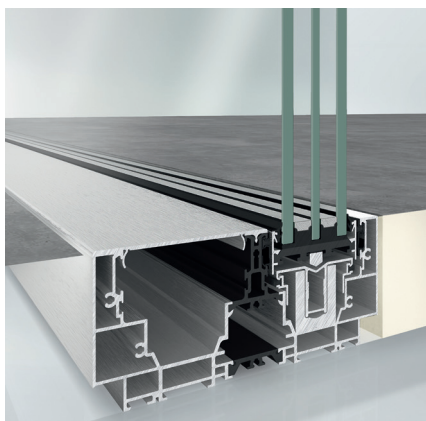

Unique lifting mechanism for Panorama Design sliding systems with barrier-free thresholds

Even the heaviest sliding doors can be effortlessly operated using our unique lifting mechanism, which also provides fully barrier-free access.

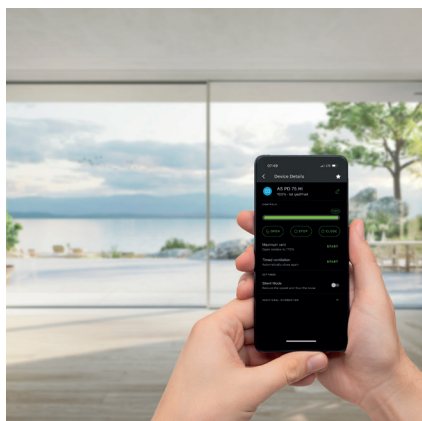

Secure smart home integration

With the TipTronic locking system, the sliding units can be operated fully automatically and contact-free via a tablet, smartphone or switch. At the same time, the new finger-trap protection software provides the highest levels of safety and comfort.

Schüco AS PD 75.HI



As a leader in innovation for system-based construction, Schüco aluminium sliding systems combine the highest standards in terms of energy safety, security and design with market-specific requirements.

Schüco International KG

www.schueco.com

www.schueco.de

Folgen Sie uns:
Follow us:



Schüco – System solutions for windows, doors and façades

Based in Bielefeld, the Schüco Group develops and sells system solutions for windows, doors and façades. With 6330 employees worldwide, the company strives to be the industry leader in terms of technology and service both now and in the future. In addition to innovative products for residential and commercial buildings, the building envelope specialist offers consultation and digital solutions for all phases of a building project – from the initial idea through to design, fabrication and installation. Schüco works with 10,000 fabricators and 30,000 architectural practices, as well as construction professionals who commission buildings around the world. Founded in 1951, the company is now active in more than 80 countries and achieved a turnover of 1.995 billion euros in 2021. For more information, visit www.schueco.com

Thermosash 
BUILDING ENVELOPE SOLUTIONS™

SCHÜCO



Overview

	Schüco ASS 77 PD.SI	Schüco ASS 77 PD.HI	Schüco ASS 50	Schüco ASS 80 FD.HI	Schüco ASS 70 FD	Schüco AS FD 90.HI	Schüco AS FD 75	Schüco AS PD 75.HI	Schüco ASE 67 PD	Schüco ASE 80.HI	Schüco ASE 80	Schüco ASE 60	Schüco AWS 90.SI+ PASK
Energy													
Thermally insulated			■		■		■		■				
High Thermally insulated	■	■		■		■		■		■	■	■	■
Design													
Basic depth of vent frame in mm	77	77	50	80	70	90	75	75	67	80	80	60	100
Number of tracks													
Single track			■	■	■	■	■		■	■	■	■	■
Double track	■	■	■					■	■	■	■	■	
Triple track			■						■	■	■	■	
Maximum vent weight in kg	500	500	400	100	100	150	150	500*	400	600	600	600	250
Fittings													
Crank handle			■										
Sliding handle			■					■**	■	■	■	■	
Tilt / slide handle													■
Folding handle				■	■	■	■						
Door handle				■	■	■	■						
Window handle				■	■	■	■						
Operating switch	■	■						■**		■	■	■	
Opening types													
Sliding vent	■	■	■					■		■	■	■	
Lift-and-slide vent			■							■	■	■	
Tilt / slide units													■
Folding sliding door				■	■	■	■						
Areas of Use													
Window	■	■	■	■	■	■	■	■		■	■	■	■
Door	■	■	■	■	■	■	■	■		■	■	■	■

*AS PD 75.HI max weight: 500kg Manual / 600kg Performance Line / 800kg Mechatronic

**AS PD 75.HI fittings: Access Line & Design Line manual or mechatronic operation / Performance Line mechatronic operation only

Overview

	Schüco ASS 77 PD.SI	Schüco ASS 77 PD.HI	Schüco ASS 50	Schüco ASS 80 FD.HI	Schüco ASS 70 FD	Schüco AS FD 90.HI	Schüco AS FD 75	Schüco AS PD 75.H	Schüco ASE 67 PD	Schüco ASE 80.HI	Schüco ASE 80	Schüco ASE 60	Schüco AWS 90.SI+ PASK
Series													
Security													
Burglar resistance in accordance with DIN EN 1627													
RC2 (WK2)	■	■	■	■	■	■	■	■		■	■	■	■
Monitoring of closing		■				■	■	■		■	■	■	
Automation													
Schüco e-slide			■										
Schüco TipTronic	■	■						■		■	■	■	
Access Control	■	■	■					■					



Thermosash

BUILDING ENVELOPE SOLUTIONS™

SCHÜCO

PARTNER

PRODUCTS

CANOPIES
SHOPFRONT
RAINSCREENS
BALUSTRADES
THERMAL BREAK
DOORS & SLIDERS
CHANNEL GLAZING
MECHANICAL LOUVRES
ROOFLIGHTS & ATRIUMS
COMMERCIAL WINDOWS
SOLARSHADING, LOUVRES & FINS
TOTAL VISION - STRUCTURAL GLAZING
UNITISED CURTAINWALL & PANELWALL FAÇADES
SCHÜCO - HIGH END RESIDENTIAL WINDOWS & DOORS

Auckland

158-164 Central Park Drive,
Henderson, Auckland 0610
PO Box 100-340, North Shore,
Auckland 0745, New Zealand
P: +64 9 444 4944
F: +64 9 444 4886

Wellington

17-19 Marine Parade, Petone,
Lower Hutt 5012, New Zealand
PO Box 38-645, Wellington Mail
Centre, Lower Hutt 5045, New Zealand
P: +64 4 939 4500
F: +64 4 939 4499

Christchurch

12 Braeburn Drive
Hornby, Christchurch 8040
PO Box 313, Christchurch 8140,
New Zealand
P: +64 4 348 4004
F: +64 4 348 4088

www.thermosash.co.nz