

NOTES:  
 1) DRAWING TO BE USED IN CONJUNCTION WITH 'MASTERSPEC' (4211)  
 2) WINDOW SYSTEMS REQUIRE SPECIFIC DESIGN DEPENDING ON SPANS, WIND-LOADS, BUILDING CONDITIONS, ETC.  
 3) INSIDE GLAZE, INTERNAL REINFORCEMENT AND SEISMIC FRAME OPTIONS AVAILABLE

GLAZING: GLASS THICKNESS TO SUIT REQUIREMENTS  
 HARDWARE: STANDARD  
 HARDWARE OPTIONS  
 FINISHES: POWDER-COAT / ANODISED / PVF<sup>2</sup>

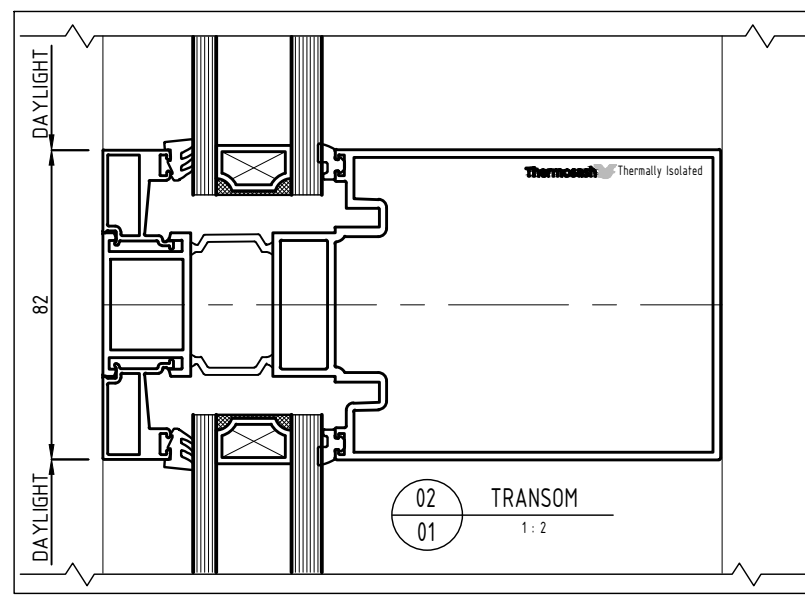

04 PARAPET HEAD  
1:2

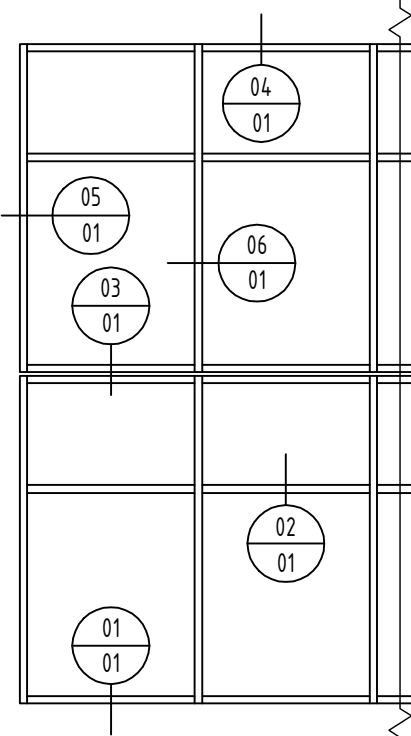
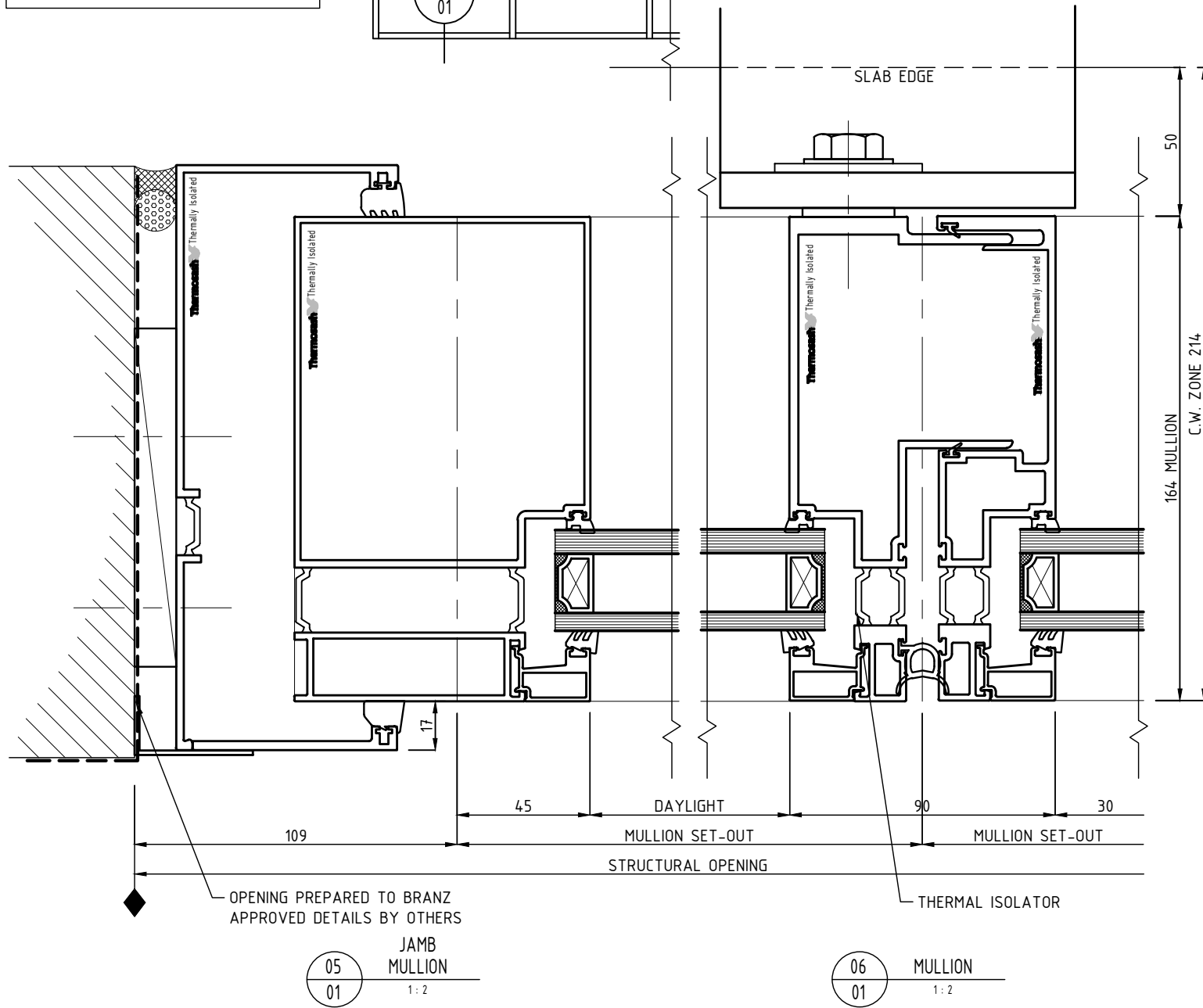

05 JAMB MULLION  
01 1:2

06 MULLION  
01 1:2

03 SPLIT TRANSOM  
01 1:2

01 SILL TRAY  
01 1:2

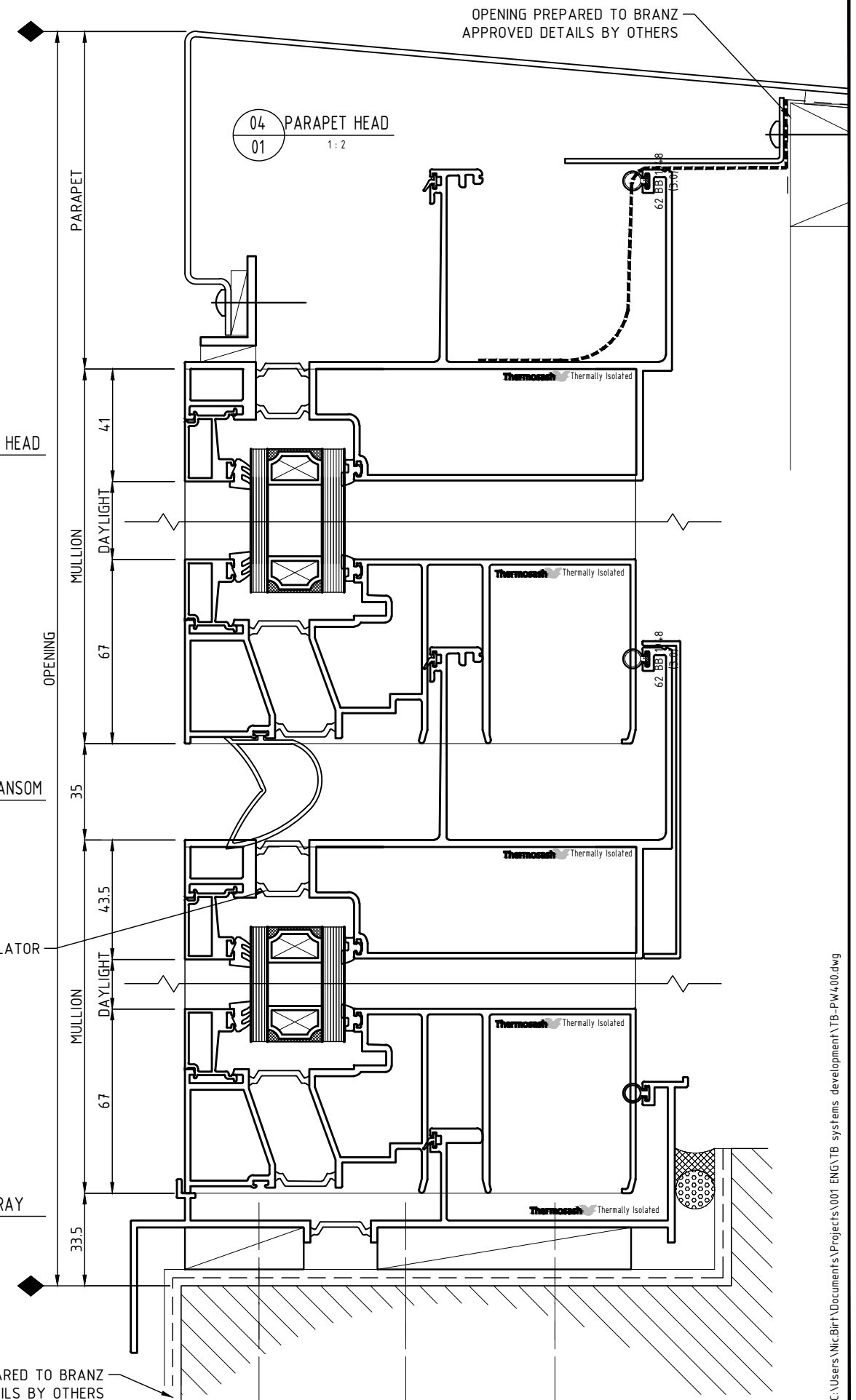

OPENING PREPARED TO BRANZ APPROVED DETAILS BY OTHERS

SYSTEM :  
**THERMALLY BROKEN PW400  
 UNITISED HIGH PERFORMANCE  
 PANEL SYSTEM**  
 www.thermosash.co.nz ~ AUCKLAND: (09)444-4944 ~ WELLINGTON: (04)939-4500 ~ CHRISTCHURCH: (03)348-4004

TYPE :  
**160mm MULLION  
 DOUBLE GLAZED (SEISMIC)**

SCALE: NTS  
 DATE: 30-Mar-23  
 PAGE: TB PW400-01



C:\Users\Nic.Bir\Documents\Projects\001 ENG\TB systems development\TB-PW400.dwg