

NOTES:
 1) DRAWING TO BE USED IN CONJUNCTION WITH 'MASTERSPEC' (4211)
 2) WINDOW SYSTEMS REQUIRE SPECIFIC DESIGN DEPENDING ON SPANS, WIND-LOADS, BUILDING CONDITIONS, ETC.
 3) INSIDE GLAZE, INTERNAL REINFORCEMENT AND SEISMIC FRAME OPTIONS AVAILABLE

GLAZING: GLASS THICKNESS TO SUIT REQUIREMENTS
 HARDWARE: STANDARD HARDWARE OPTIONS
 FINISHES: POWDER-COAT / ANODISED / PVF²

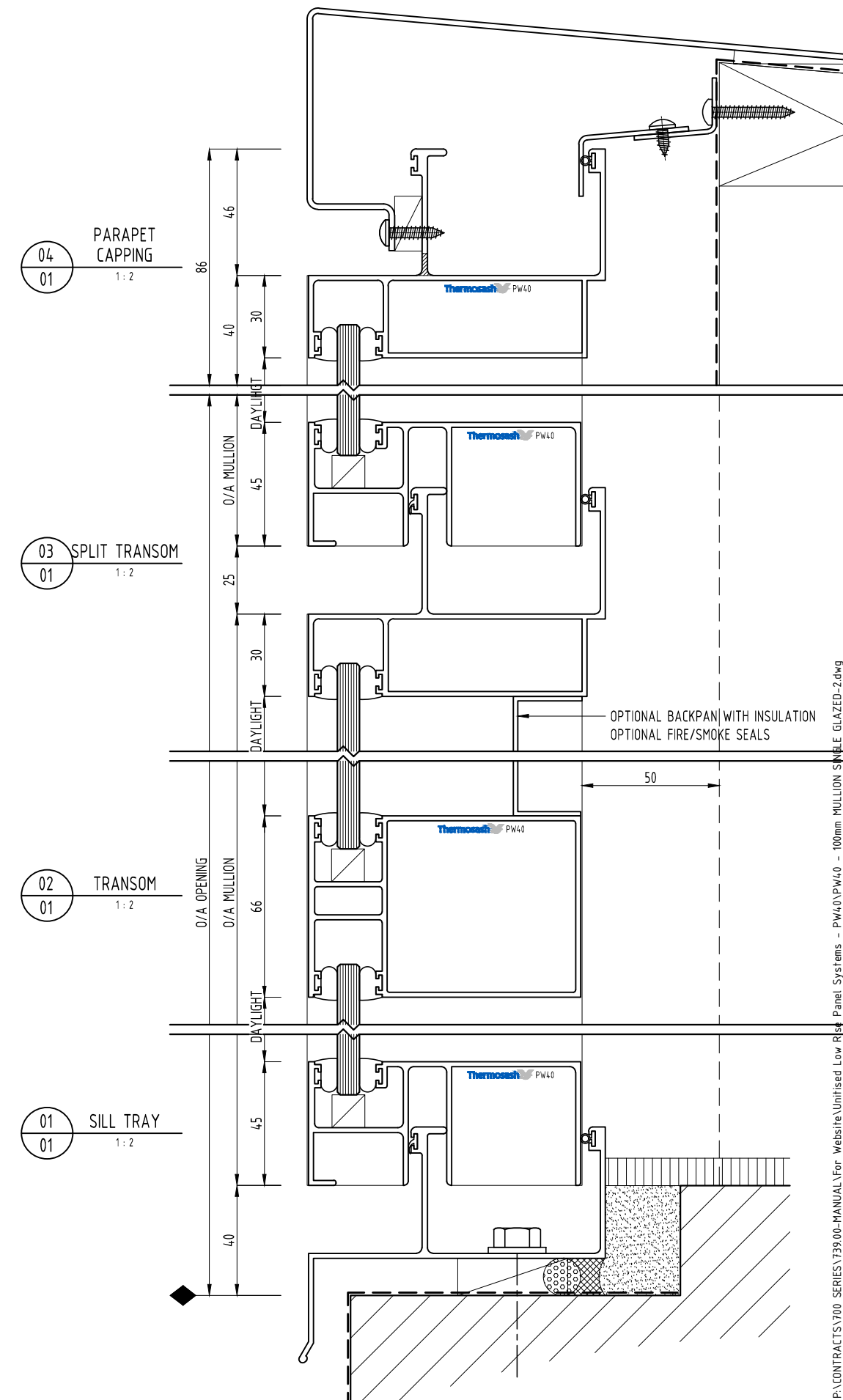
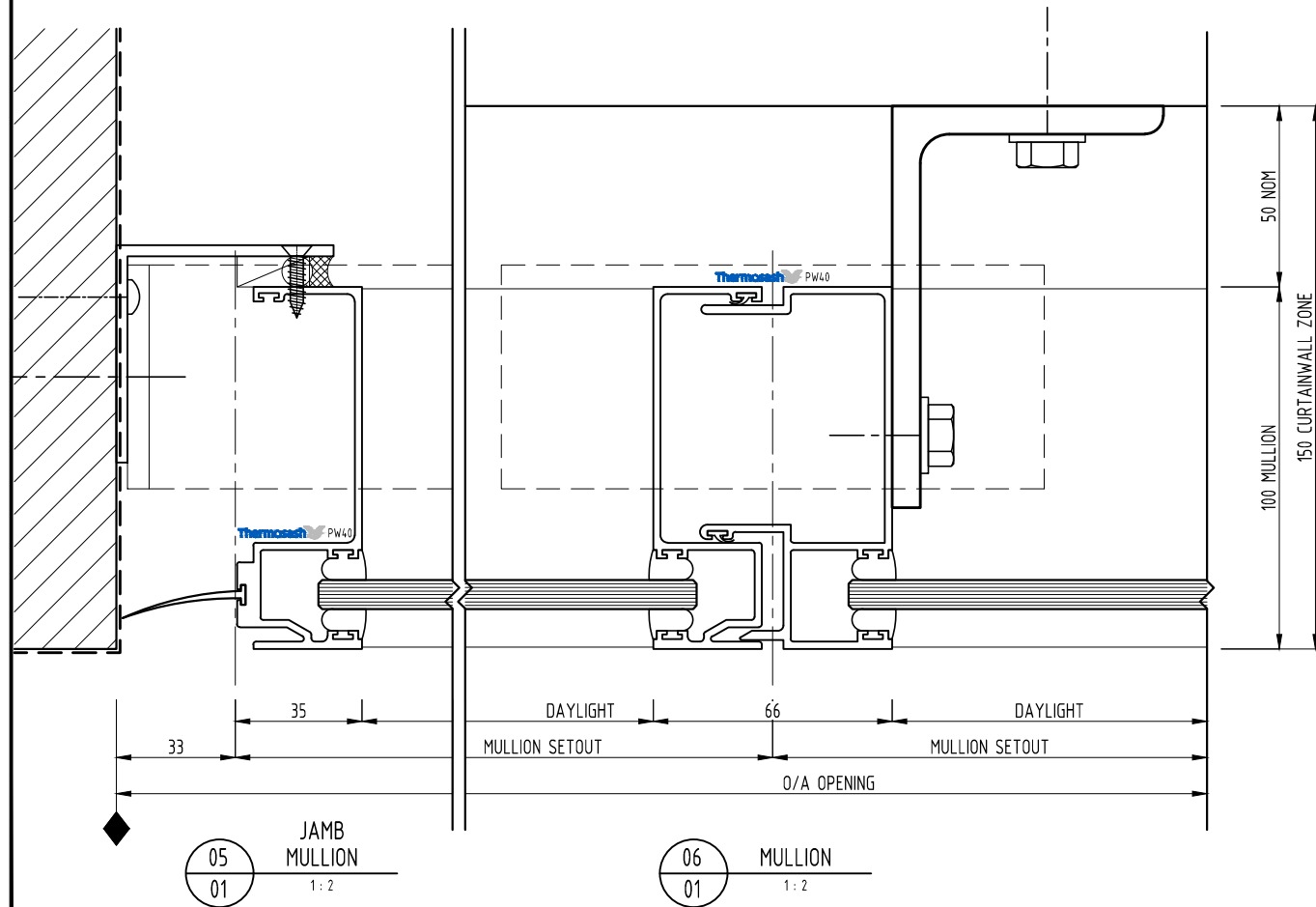
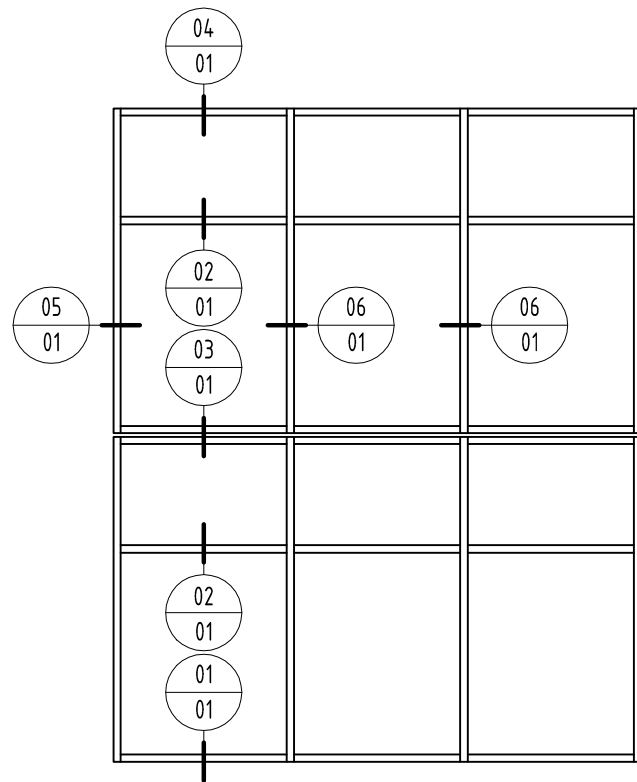

SYSTEM :
 PW40
 UNITISED LOWRISE PANEL SYSTEMS

TYPE :
 100mm MULLION
 SINGLE GLAZED

www.thermosash.co.nz ~ AUCKLAND: (09)444-4944 ~ WELLINGTON: (04)939-4500 ~ CHRISTCHURCH: (03)348-4004

SCALE:
 1:2 @ A3

DATE:
 Dec-12

PAGE:
 PW40-01



P:\CONTRACTS\700 SERIES\739.00-MANUAL\For Website\Utilised Low Rise Panel Systems - PW40\PW40 - 100mm MULLION SINGLE GLAZED-2.dwg