

NOTES:
 1) DRAWING TO BE USED IN CONJUNCTION WITH 'MASTERSPEC' (4211)
 2) WINDOW SYSTEMS REQUIRE SPECIFIC DESIGN DEPENDING ON SPANS, WIND-LOADS, BUILDING CONDITIONS, ETC.
 3) INSIDE GLAZE, INTERNAL REINFORCEMENT AND SEISMIC FRAME OPTIONS AVAILABLE

GLAZING: GLASS THICKNESS TO SUIT REQUIREMENTS
 HARDWARE: STANDARD HARDWARE OPTIONS
 FINISHES: POWDER-COAT / ANODISED / PVF²

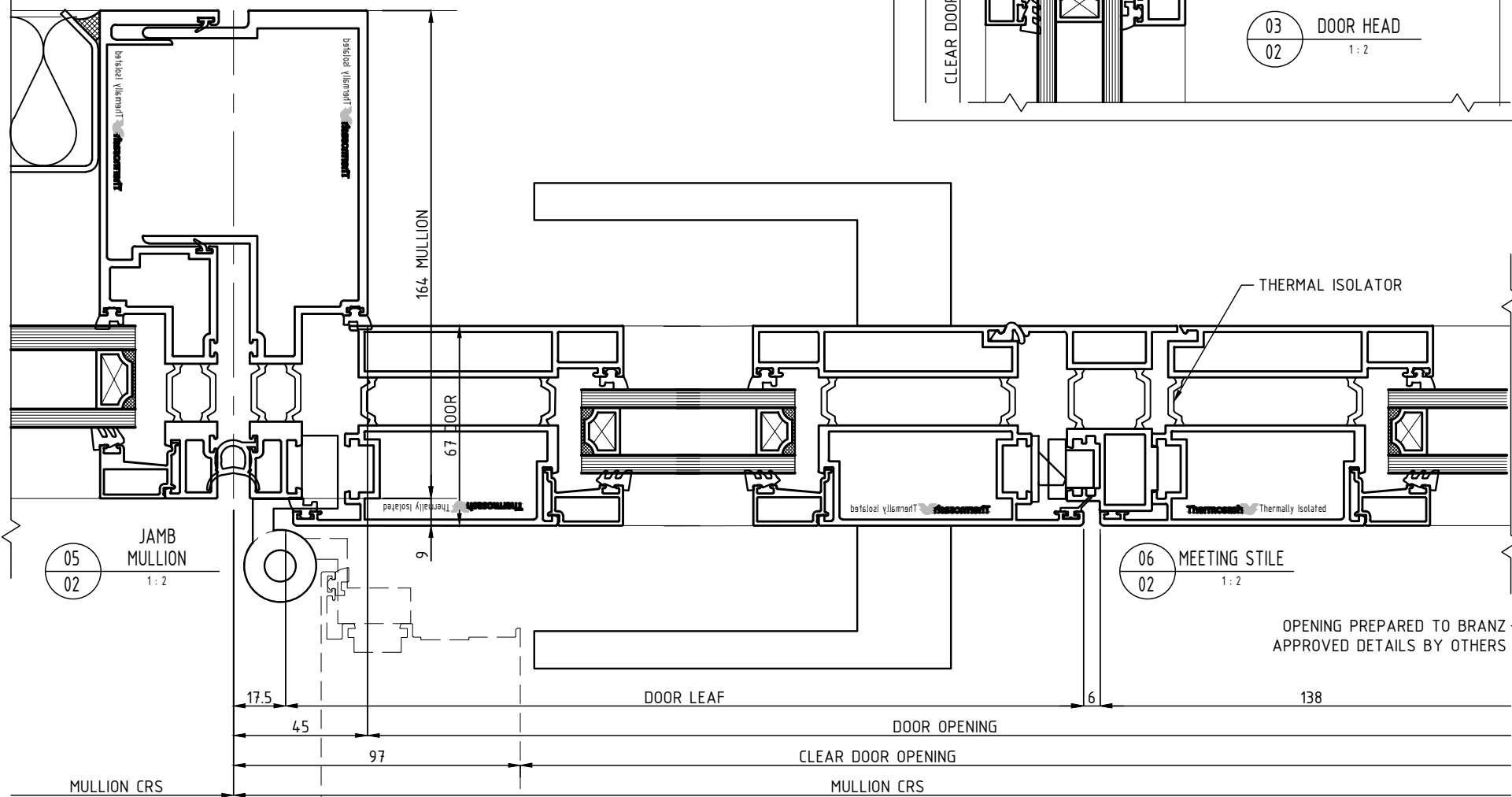
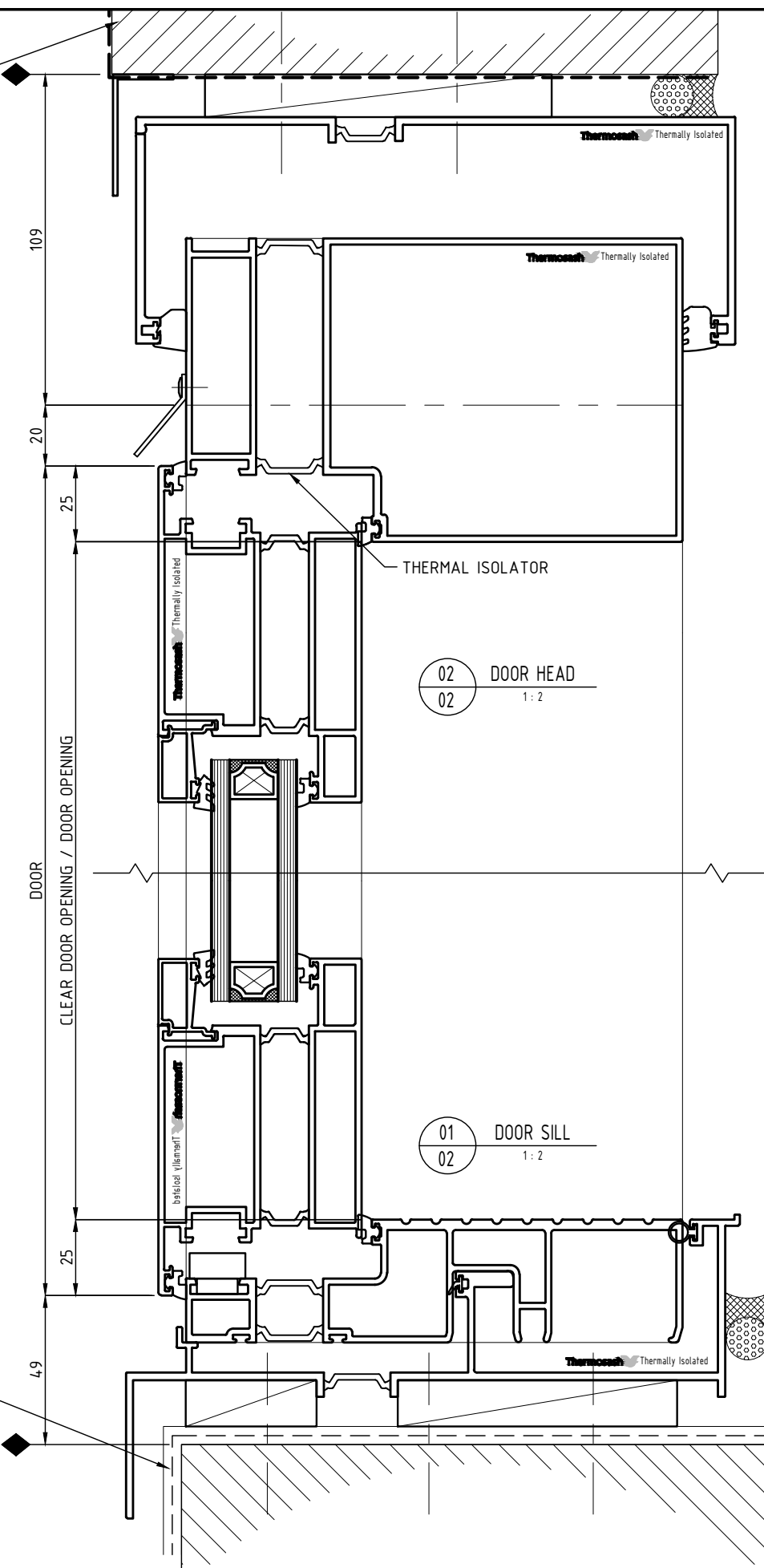
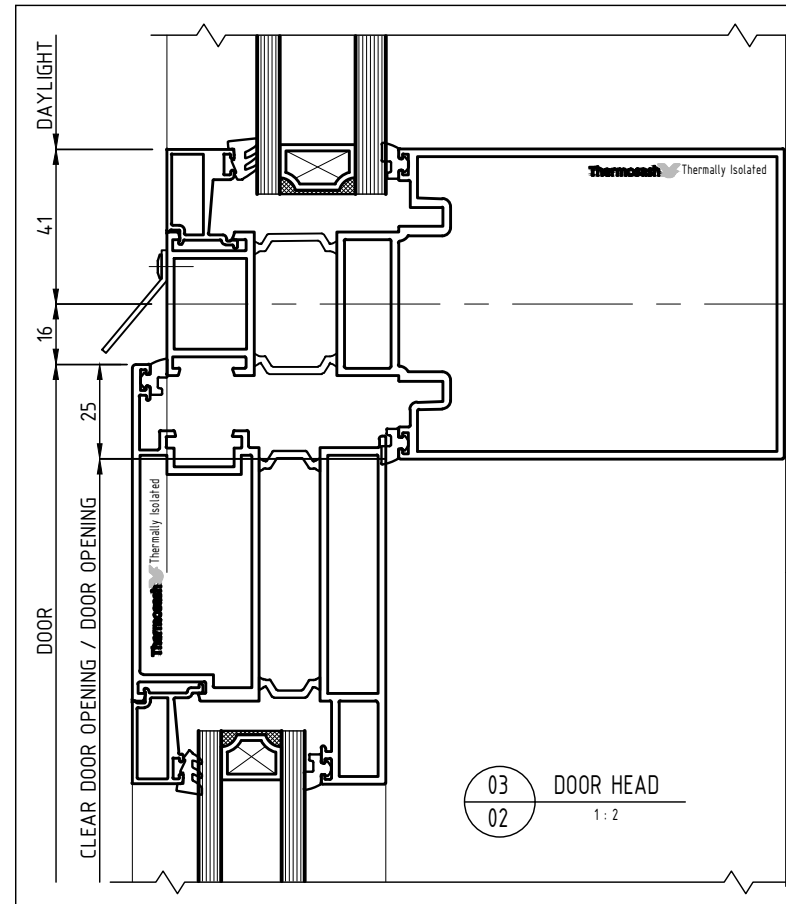
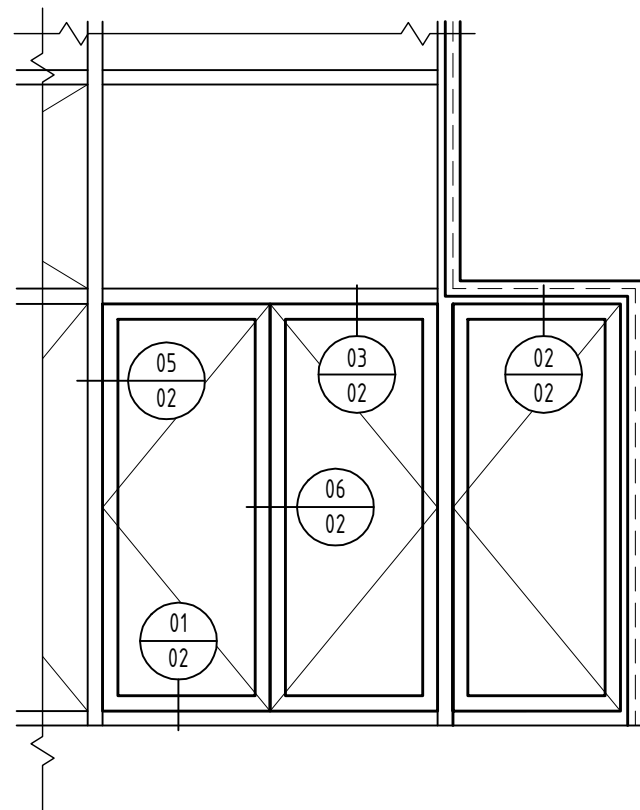

SYSTEM : THERMALLY BROKEN PW400 UNITISED HIGH PERFORMANCE PANEL SYSTEM <small>www.thermosash.co.nz ~ AUCKLAND: (09)444-4944 ~ WELLINGTON: (04)939-4500 ~ CHRISTCHURCH: (03)348-4004</small>	TYPE : 160mm MULLION DOUBLE GLAZED DOORS	SCALE: NTS	DATE: 30-Mar-23	
		PAGE: TB PW400-02		

C:\Users\Mic.Birt\Documents\Projects\01_EKG\78 systems development\TB-PW400.dwg