

NOTES:  
 1) DRAWING TO BE USED IN CONJUNCTION WITH 'MASTERSPEC' (4521)  
 2) WINDOW SYSTEMS REQUIRE SPECIFIC DESIGN DEPENDING ON SPANS, WIND-LOADS, CLADDING SPECIFIED, ETC.  
 3) INTERNAL REINFORCEMENT OPTIONS AVAILABLE

GLAZING: GLASS THICKNESS TO SUIT REQUIREMENTS  
 HARDWARE: VARIOUS STANDARD HARDWARE OPTIONS AVAILABLE (OR CALL TO DISCUSS SPECIFIC COMPONENTS)  
 FINISHES: POWDER-COAT / ANODISED / PVF<sup>2</sup>

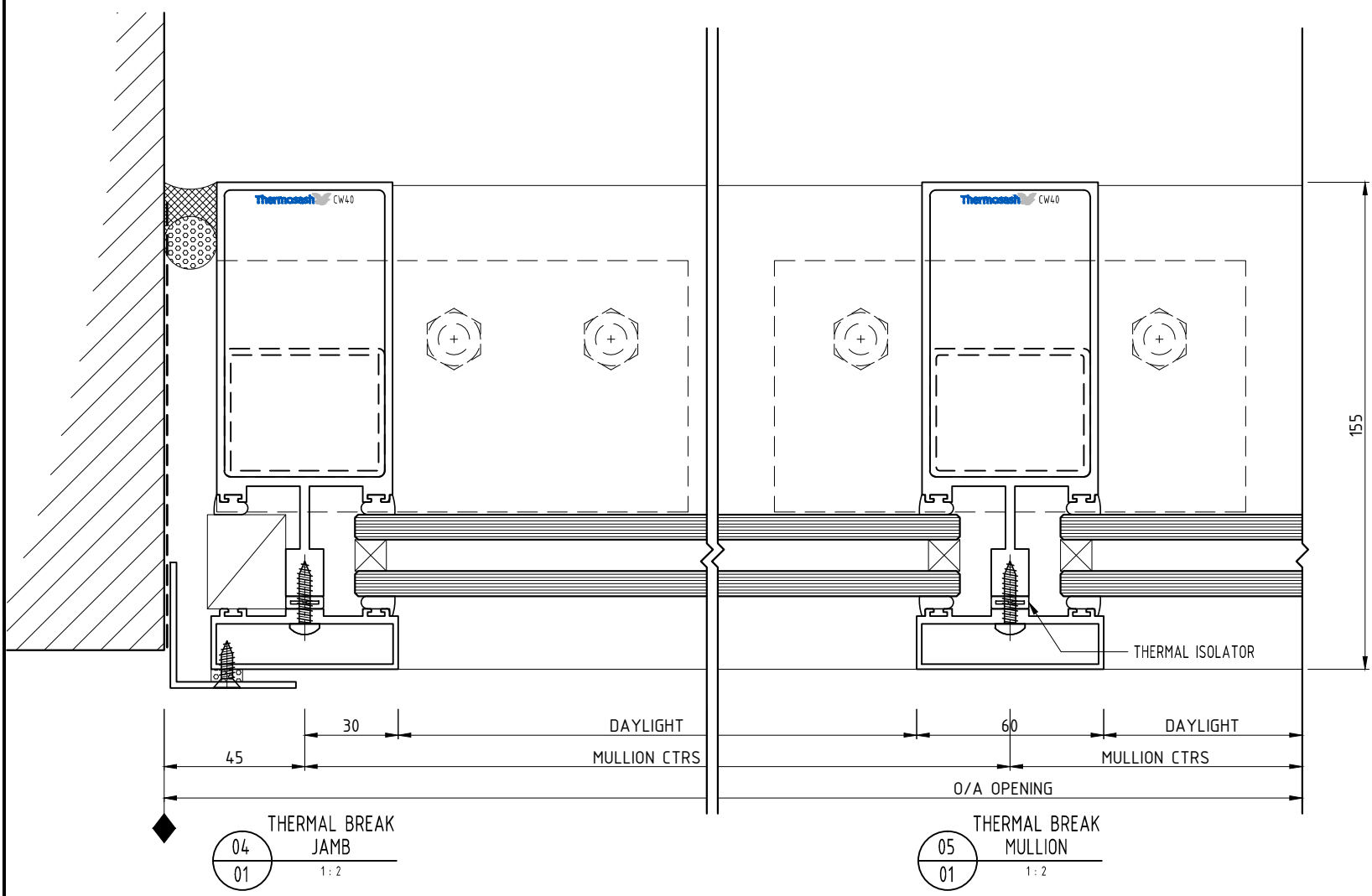

03  
01  
THERMAL BREAK HEAD  
1:2

02  
01  
THERMAL BREAK TRANSOM  
1:2

01  
01  
THERMAL BREAK SILL  
1:2

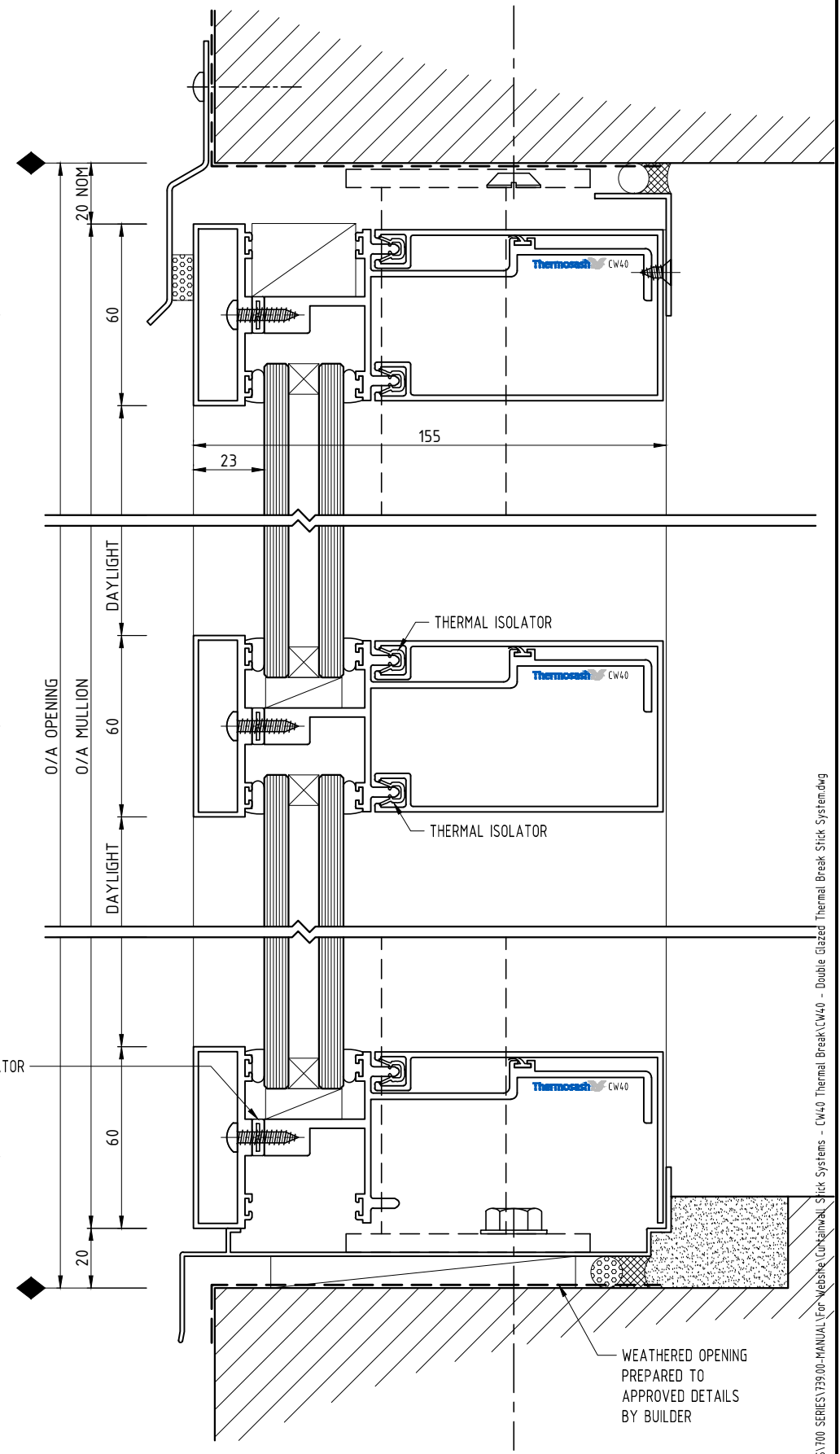

SYSTEM: CW 40 LOW RISE THERMALLY BROKEN STICK SYSTEM www.thermosash.co.nz ~AUCKLAND: (09)444-4944 ~WELLINGTON: (04)939-4500 ~CHRISTCHURCH: (03)348-4004	TYPE: DOUBLE GLAZED	SCALE: 1:2 @ A3	DATE: Dec-12
		PAGE: CW40-01	



P:\CONTRACTS\700 - SERIES\739-00-MANUAL FOR WEATHERED OPENING (CONTRACT) - Double Glazed Thermal Break Stick System.dwg